

Quick Reference Test Pit Digging Guide

Step	Where to work	What to do
1	Booklet	Fill out all boxes on the front cover of your Digging an Archaeological Test Pit Excavation Record booklet.
2	On marked test pit site	Measure out your 1 m square test pit with tape, string and nails.
3	Around test pit	Measure and draw a location sketch plan to record test pit location.
4	Near test pit	Lay out your plastic sheeting at least 2 m away from test pit.
5	Booklet	Fill in details on top right-hand side of the first Context Record Sheet page in your Digging an Archaeological Test Pit Excavation Record
6	Booklet	Complete recording steps 1–4 on the Context Record Sheet , including drawing a plan of the surface of the pit in the gridded square at 1:10 scale.
7	Beside test pit	Line an empty finds tray with newspaper.
8	Beside test pit	Label a plastic resealable finds bag in permanent marker pen with the site-name, test pit number and context number, and place it in the finds tray.
9	In test pit	(Before first context ONLY) Remove turf (if present) with spade, in squares as neatly as possible.
10	In test pit & on spoil heap	Use mattock to loosen soil in test pit, and the shovel to put it into bucket. Keep the bottom of the test pit as level as possible and the sides straight. Try not to get soil on the grass.
11	On spoil heap	Sieve every bucketful of soil (holding the sieve over the plastic sheeting). Pick out of the sieve anything you see that looks man-made (these are your finds) and tip the residue onto the spoil heap on top of the plastic sheeting.
12	Beside test pit	Clean any finds and place them in the finds tray to dry (only put them in the finds bag when they are dry).
13	In test pit	Continue until you have removed 10 cm from the whole surface of the test pit.
14	In test pit	Use your trowel and hand shovel to remove all loose soil from the exposed surface and leave it level.
15	Booklet	Fill in the rest of the Context Record Sheet by filling in boxes steps 5–7.
16	Booklet	Begin your next context by starting a new Context Record Sheet , i.e. by returning to step 5.
Repeat steps 5–16 (omitting step 9) for context 2 and all subsequent contexts until you have finished your test pit, then go on to step 17.		
17	Booklet	Fill in the details on the top left hand side of the FINAL Context Record Sheet page in your Digging an Archaeological Test Pit Excavation Record complete all 7 recording steps.
18	Booklet	Fill in all parts of the final Section Drawing Sheets .
19	In test pit	Back-fill your test pit and replace turf AS NEATLY AS POSSIBLE .
20	In test pit	Tidy site, collect up and clean your equipment and return with everything to the excavation base.

Digging an Archaeological Test Pit Excavation Record

Date of excavation: 20th June 2015 Site code/settlement name: SBR 15
 Test-pit number: TP 51 Test-pit address: Nest Cottage
 Test-pit team names: DAYCOTT HALL
 1. Sue Nicholson, Miles Johnson 3. Looby Dolsey, Amy Mitchell
 2. Ann + John Russell, David Brooks 4. Matt Bullimore, Delyth Rennie

Test Pit Location Map

Site code: **SBD F15** Test Pit number: **51**

Site measured by: **David + Matt + Miles + Lesley**

Map drawn by: **Amy**

Test pit location recording checklist	
Task	Tick when completed
Measure and draw map of area around your test pit with North marked.	<input checked="" type="checkbox"/>
Add written description of test-pit location	<input checked="" type="checkbox"/>

1. Make a measured, labelled plan of the unexcavated surface the test pit, showing where it is in relation to features such as houses, boundaries, roads, walls etc which are marked on your Ordnance Survey map. Include lines showing the exact distances from your test pit to permanently identifiable points nearby such as buildings or field corners. Show your test pit as a square with the corners numbered 1-4, to correlate with the numbers on each context plan in the **Context Record Sheets** in this **Record Booklet**.

2. Draw an arrow here pointing in the direction of North on your map:

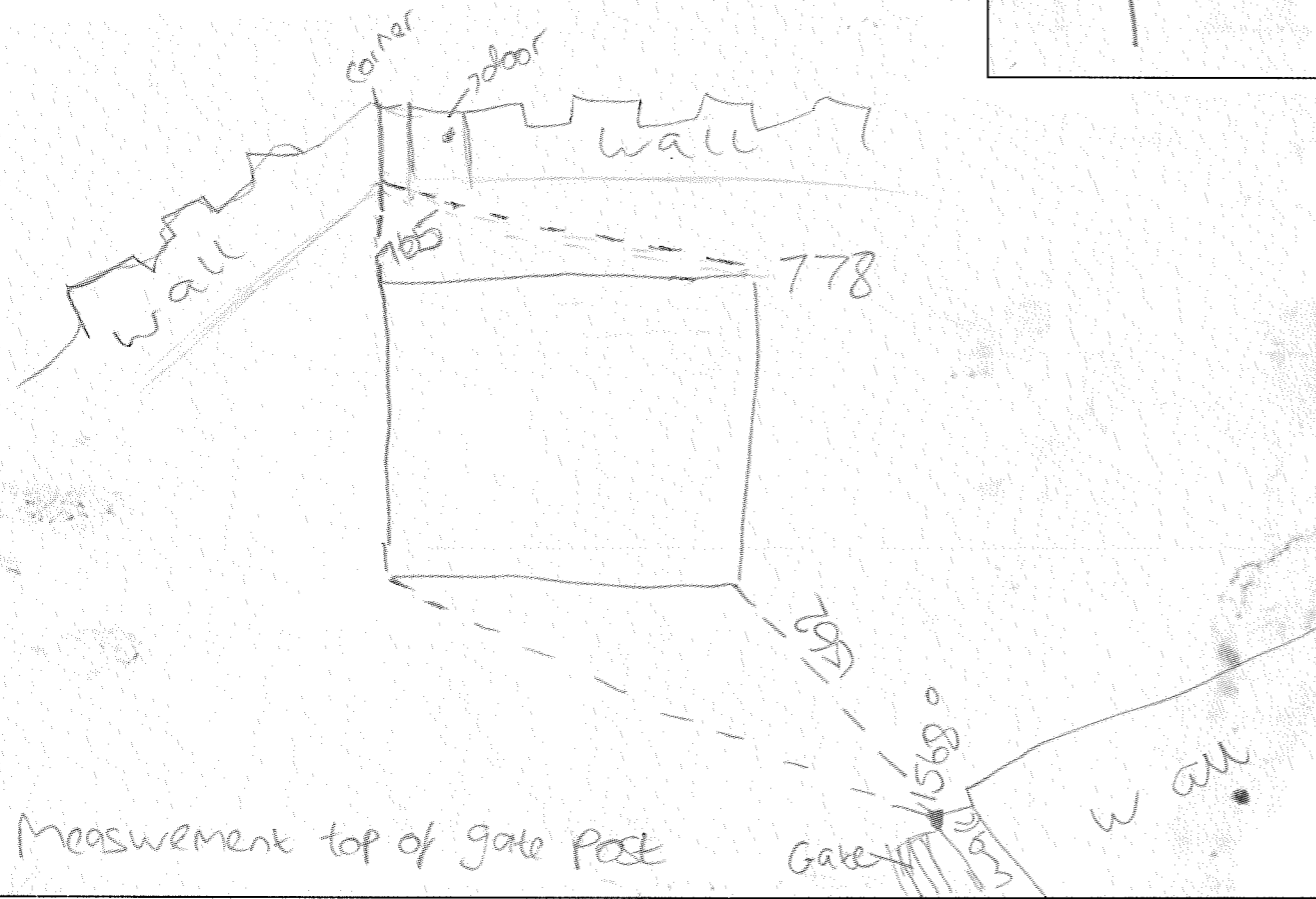

3. Describe where your test pit is, adding any notes which help explain this to someone who doesn't know your site:

Test pit is in garden surrounded by a wall and on a slope situated in left hand corner at the top.

Section Drawings

Site code: **SBD F15** Test Pit number: **51**

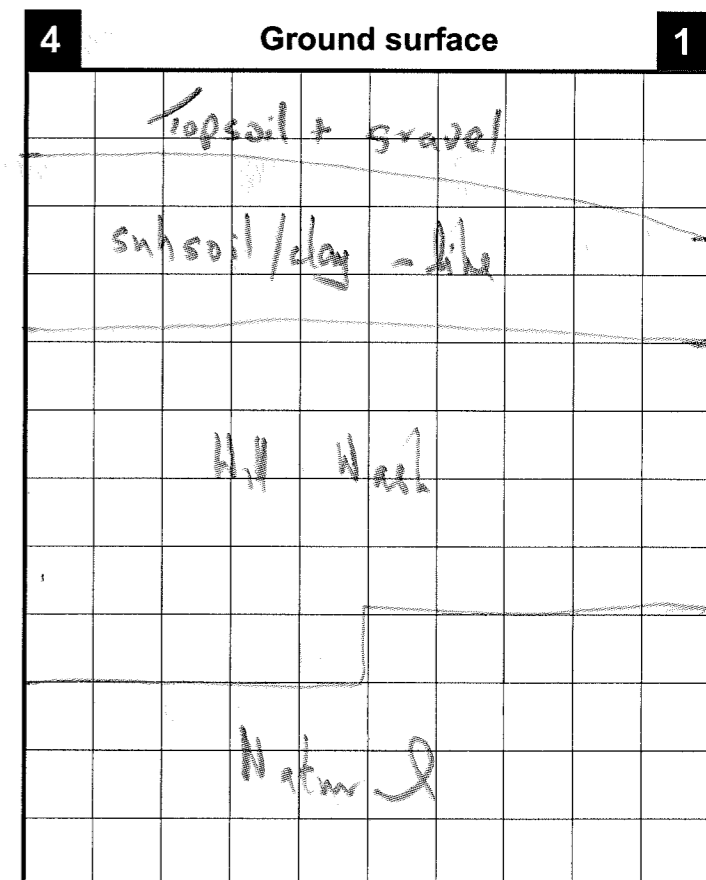
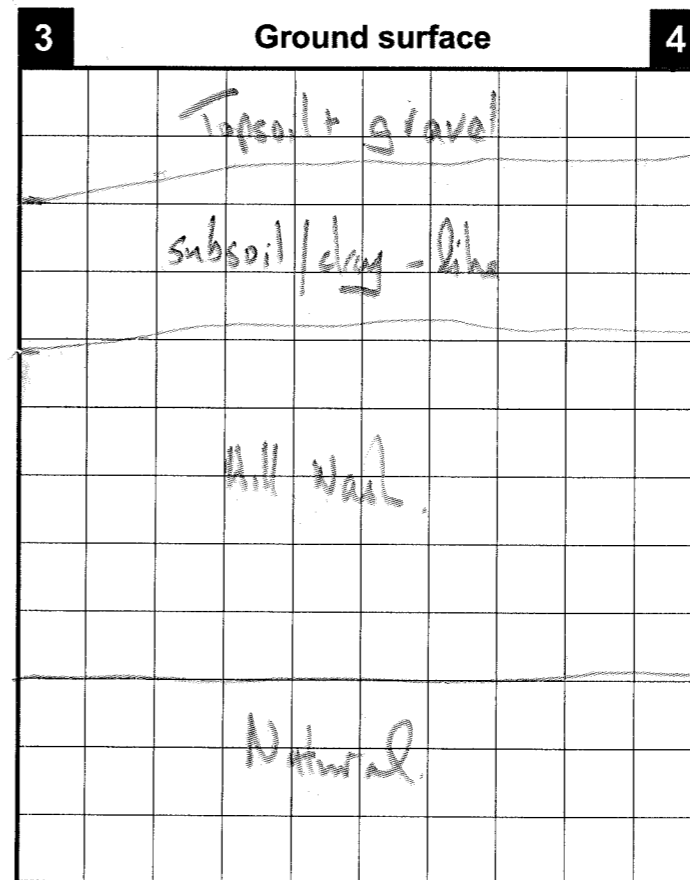
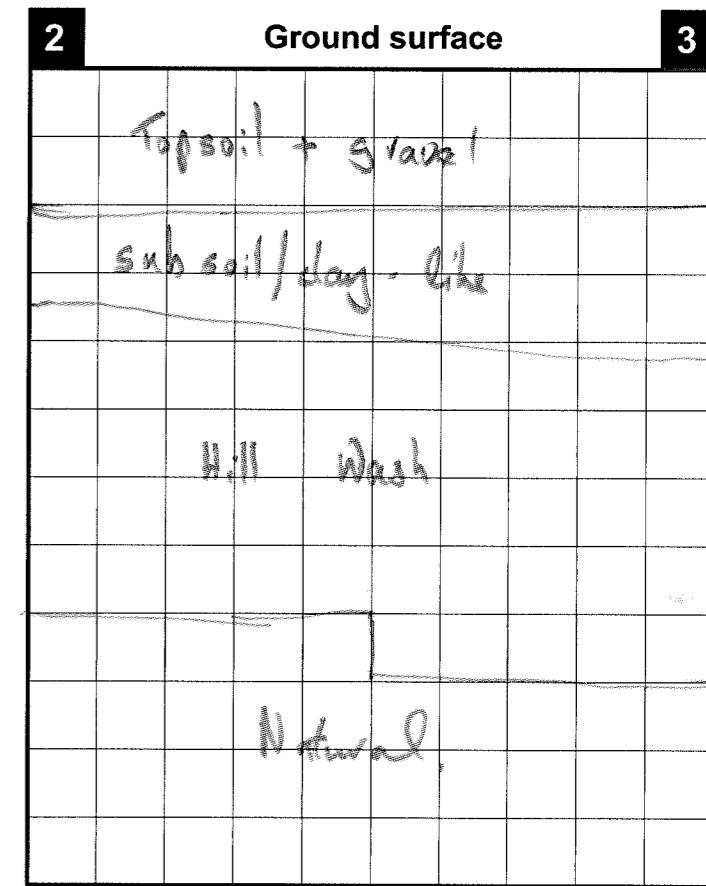
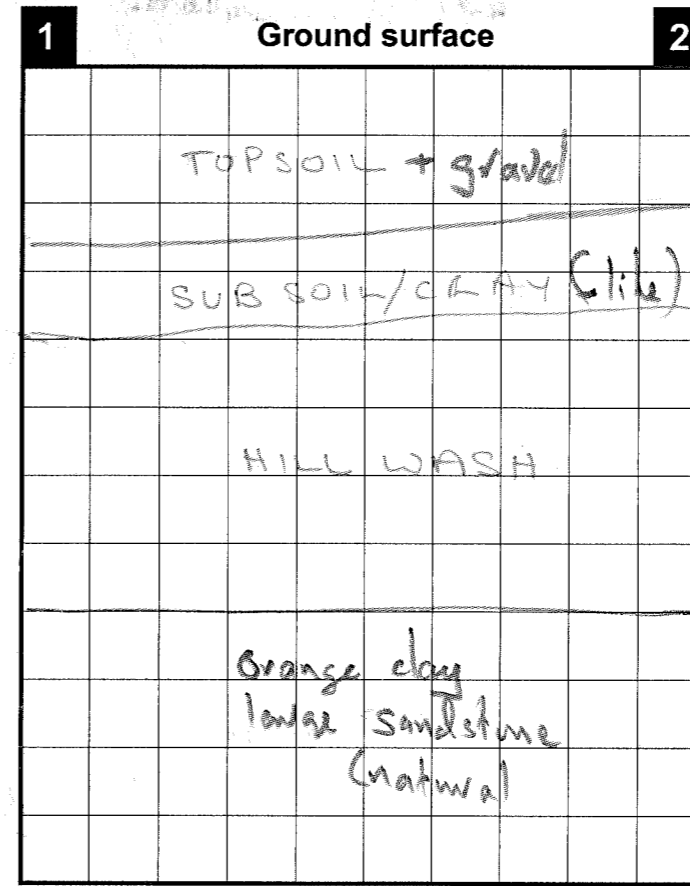

FINAL Context Record Sheet

Site code: **SBOR 15** Test Pit number: **51** Context number: **10**

Context recorded by: **Dave Brink**

1. What depth is the surface of the top of this context at the four corners of your test pit (numbered in black boxes below)?
1 **80** 2 **80** 3 **90** 4 **90**

2. Make a measured, labelled plan of this context in the gridded square below (1 cm on paper = 10 cm in pit)

3. Draw an arrow here pointing in the direction of North on your plan:

1 Final (unexcavated) context plan

4. Describe what you've drawn on the plan, adding any notes which help explain what you have shown on your plan:
Excavated S section of pit only revealed area of ferruginous silt (ie sandy clay + sandstones)

Final Context Recording task checklist	
Task (complete all these before starting to backfill)	Tick when completed
Photograph surface of bottom of test pit	<input checked="" type="checkbox"/>
Draw plan of bottom of test pit	<input checked="" type="checkbox"/>
Complete section drawings for all 4 sides of your test pit	<input checked="" type="checkbox"/>
Ensure all finds are clean and in clearly labelled bags	<input checked="" type="checkbox"/>
Fill in all sections on this Final Context Recording Sheet	<input checked="" type="checkbox"/>

6. Did you excavate your test pit to natural? If not, explain why you stopped digging.
Yes.
No finds.

7. Use this space for your conclusions about how well your test-pit excavation went, what you think it revealed, any technical problems you encountered which may have affected the results, and any other thoughts that might be useful when writing up your test-pit excavation:

Context Record Sheet

Site code: **SBOR 15** Test Pit number: **PS1** Context number: **1**

Context recorded by: **MATT**

1. What depth is the surface of the top of this context at the four corners of your test pit (numbered in black boxes below)?
1 **0 cm** 2 **0 cm** 3 **0 cm** 4 **0 cm**

2. Make a measured, labelled plan of this context in the gridded square below (1 cm on paper = 10 cm in pit)

3. Draw an arrow here pointing in the direction of North on your plan:

1 Context plan

4. Describe what you've drawn on the plan, adding any notes which help explain what you have shown on your plan:

Recording task checklist	
Task	Tick when completed
Photograph top of layer before starting to dig it	<input checked="" type="checkbox"/>
Draw plan of top of context before starting to dig it	<input checked="" type="checkbox"/>
Dig context, sieve spoil, keep and record finds (record percentage sieved)	100 %
Clean finds and place in clearly labelled finds tray to dry with labeled bag	<input checked="" type="checkbox"/>
Fill in all of this Context Record Sheet	

5. Complete the boxes below to show what (apart from finds) was in this context (write non-listed inclusions into blank row if necessary):

	Present y/n	Percentage?	Particle size (tick each box that applies)		
			Small	Med	Large
Stone	Y	% 55	<input checked="" type="checkbox"/>		
Sand		%	<input type="checkbox"/>	<input type="checkbox"/>	<input type="checkbox"/>
Soil	Y	% 45	<input checked="" type="checkbox"/>	<input type="checkbox"/>	<input type="checkbox"/>
Clay		%	<input type="checkbox"/>	<input type="checkbox"/>	<input type="checkbox"/>
Charcoal	Y	% < 1	<input checked="" type="checkbox"/>	<input type="checkbox"/>	<input type="checkbox"/>
		%	<input type="checkbox"/>	<input type="checkbox"/>	<input type="checkbox"/>
		%	<input type="checkbox"/>	<input type="checkbox"/>	<input type="checkbox"/>

6. What colour was this context?: **2**

7. List the finds from this context. For each find, say what it is (or what it looks like) and what date it is (if you know).
POT - terracotta glazed
COAL
GLASS
plastic
slag
Bone

Context Record Sheet

Site code: **SBDF15** Test Pit number: **51** Context number: **2**

Context recorded by: **DELYTH RENNIE**

1. What depth is the surface of the top of this context at the four corners of your test pit (numbered in black boxes below)?
1 **10cm** 2 **10cm** 3 **10cm** 4 **10cm**

2. Make a measured, labelled plan of this context in the gridded square below (1 cm on paper = 10 cm in pit)

3. Draw an arrow here pointing in the direction of North on your plan:

1 Context plan **2**

4 **3**

4. Describe what you've drawn on the plan, adding any notes which help explain what you have shown on your plan:
Note - we were advised that at a while the site had been where a garden bench on a gravel bed had been sited

Recording task checklist	
Task	Tick when completed
Photograph top of layer before starting to dig it	<input checked="" type="checkbox"/>
Draw plan of top of context before starting to dig it	<input checked="" type="checkbox"/>
Dig context, sieve spoil, keep and record finds (record percentage sieved)	100 %
Clean finds and place in clearly labelled finds tray to dry with labeled bag	<input checked="" type="checkbox"/>
Fill in all of this Context Record Sheet	<input checked="" type="checkbox"/>

5. Complete the boxes below to show what (apart from finds) was in this context (write non-listed inclusions into blank row if necessary):

	Present y/n	Percentage?	Particle size (tick each box that applies)		
			Flecks	Small	Med
Stone	<input checked="" type="checkbox"/>	% 20	<input checked="" type="checkbox"/>	<input checked="" type="checkbox"/>	<input type="checkbox"/>
Sand	<input type="checkbox"/>	%	<input type="checkbox"/>	<input type="checkbox"/>	<input type="checkbox"/>
Soil	<input checked="" type="checkbox"/>	% 80	<input checked="" type="checkbox"/>	<input type="checkbox"/>	<input type="checkbox"/>
Clay	<input type="checkbox"/>	%	<input type="checkbox"/>	<input type="checkbox"/>	<input type="checkbox"/>
Charcoal	<input type="checkbox"/>	%	<input type="checkbox"/>	<input type="checkbox"/>	<input type="checkbox"/>
	<input type="checkbox"/>	%	<input type="checkbox"/>	<input type="checkbox"/>	<input type="checkbox"/>
	<input type="checkbox"/>	%	<input type="checkbox"/>	<input type="checkbox"/>	<input type="checkbox"/>

6. What colour was this context?: **3**

7. List the finds from this context. For each find, say what it is (or what it looks like) and what date it is (if you know).
Coal - unburnt
clear glass
green bottle (?) glass
Terra cotta pot?
glazed pot
slag? (1 piece)
green plastic

Context Record Sheet

Site code: **SBDF15** Test Pit number: **51** Context number: **9**

Context recorded by: **Dave Booth**

1. What depth is the surface of the top of this context at the four corners of your test pit (numbered in black boxes below)?
1 **80** 2 **80** 3 **80** 4 **80**

2. Make a measured, labelled plan of this context in the gridded square below (1 cm on paper = 10 cm in pit)

3. Draw an arrow here pointing in the direction of North on your plan:

1 Context plan **2**

4 **3**

4. Describe what you've drawn on the plan, adding any notes which help explain what you have shown on your plan:

Recording task checklist	
Task	Tick when completed
Photograph top of layer before starting to dig it	<input checked="" type="checkbox"/>
Draw plan of top of context before starting to dig it	<input checked="" type="checkbox"/>
Dig context, sieve spoil, keep and record finds (record percentage sieved)	<input checked="" type="checkbox"/> %
Clean finds and place in clearly labelled finds tray to dry with labeled bag	<input checked="" type="checkbox"/>
Fill in all of this Context Record Sheet	<input checked="" type="checkbox"/>

5. Complete the boxes below to show what (apart from finds) was in this context (write non-listed inclusions into blank row if necessary):

	Present y/n	Percentage?	Particle size (tick each box that applies)		
			Flecks	Small	Med
Stone	<input checked="" type="checkbox"/>	% 20	<input checked="" type="checkbox"/>	<input checked="" type="checkbox"/>	<input checked="" type="checkbox"/>
Sand	<input type="checkbox"/>	%	<input type="checkbox"/>	<input type="checkbox"/>	<input type="checkbox"/>
Soil	<input checked="" type="checkbox"/>	% 70	<input checked="" type="checkbox"/>	<input type="checkbox"/>	<input type="checkbox"/>
Clay	<input checked="" type="checkbox"/>	% 10	<input checked="" type="checkbox"/>	<input type="checkbox"/>	<input type="checkbox"/>
Charcoal	<input type="checkbox"/>	%	<input type="checkbox"/>	<input type="checkbox"/>	<input type="checkbox"/>
	<input type="checkbox"/>	%	<input type="checkbox"/>	<input type="checkbox"/>	<input type="checkbox"/>
	<input type="checkbox"/>	%	<input type="checkbox"/>	<input type="checkbox"/>	<input type="checkbox"/>

6. What colour was this context?: **3/4 + clay patches 7**

7. List the finds from this context. For each find, say what it is (or what it looks like) and what date it is (if you know).
No finds

Context Record Sheet

Site code: SBDFL5 Test Pit number: 51 Context number: 4

Context recorded by: MATT

1. What depth is the surface of the top of this context at the four corners of your test pit (numbered in black boxes below)?
1 30cm 2 30cm 3 30cm 4 30cm

2. Make a measured, labelled plan of this context in the gridded square below (1 cm on paper = 10 cm in pit)

3. Draw an arrow here pointing in the direction of North on your plan:

1 Context plan **2**

4 **3**

4. Describe what you've drawn on the plan, adding any notes which help explain what you have shown on your plan:

Recording task checklist	
Task	Tick when completed
Photograph top of layer before starting to dig it	<input checked="" type="checkbox"/>
Draw plan of top of context before starting to dig it	<input checked="" type="checkbox"/>
Dig context, sieve spoil, keep and record finds (record percentage sieved)	<u>100</u> %
Clean finds and place in clearly labelled finds tray to dry with labeled bag	<input checked="" type="checkbox"/>
Fill in all of this Context Record Sheet	<input checked="" type="checkbox"/>

5. Complete the boxes below to show what (apart from finds) was in this context (write non-listed inclusions into blank row if necessary):

	Present y/n	Percentage?	Particle size (tick each box that applies)			
			Flecks	Small	Med	Large
Stone	<u>y</u>	<u>% 15</u>		<input checked="" type="checkbox"/>		
Sand		<u>%</u>				
Soil	<u>y</u>	<u>% 84</u>				
Clay		<u>%</u>				
Charcoal	<u>y</u>	<u>% 1</u>		<input checked="" type="checkbox"/>		
		<u>%</u>				
		<u>%</u>				

6. What colour was this context?: 3/4

7. List the finds from this context. For each find, say what it is (or what it looks like) and what date it is (if you know).
SLAG
POTTERY
BONE
COAL
Powderbin

Context Record Sheet

Site code: Test Pit number: Context number:

Context recorded by:

1. What depth is the surface of the top of this context at the four corners of your test pit (numbered in black boxes below)?
1 2 3 4

2. Make a measured, labelled plan of this context in the gridded square below (1 cm on paper = 10 cm in pit)

3. Draw an arrow here pointing in the direction of North on your plan:

1 Context plan **2**

4 **3**

4. Describe what you've drawn on the plan, adding any notes which help explain what you have shown on your plan:

Recording task checklist	
Task	Tick when completed
Photograph top of layer before starting to dig it	<input type="checkbox"/>
Draw plan of top of context before starting to dig it	<input type="checkbox"/>
Dig context, sieve spoil, keep and record finds (record percentage sieved)	<u> </u> %
Clean finds and place in clearly labelled finds tray to dry with labeled bag	<input type="checkbox"/>
Fill in all of this Context Record Sheet	<input type="checkbox"/>

5. Complete the boxes below to show what (apart from finds) was in this context (write non-listed inclusions into blank row if necessary):

	Present y/n	Percentage?	Particle size (tick each box that applies)			
			Flecks	Small	Med	Large
Stone		<u>%</u>				
Sand		<u>%</u>				
Soil		<u>%</u>				
Clay		<u>%</u>				
Charcoal		<u>%</u>				
		<u>%</u>				
		<u>%</u>				

6. What colour was this context?:

7. List the finds from this context. For each find, say what it is (or what it looks like) and what date it is (if you know).

Context Record Sheet

Site code: **SBD F15** Test Pit number: **51** Context number: **6**

Context recorded by: **MATT**

Recording task checklist	
Task	Tick when completed
Photograph top of layer before starting to dig it	<input checked="" type="checkbox"/>
Draw plan of top of context before starting to dig it	<input checked="" type="checkbox"/>
Dig context, sieve spoil, keep and record finds (record percentage sieved)	100 %
Clean finds and place in clearly labelled finds tray to dry with labeled bag	<input checked="" type="checkbox"/>
Fill in all of this Context Record Sheet	<input checked="" type="checkbox"/>

1. What depth is the surface of the top of this context at the four corners of your test pit (numbered in black boxes below)?
1 **50** 2 **50** 3 **50** 4 **50**

2. Make a measured, labelled plan of this context in the gridded square below (1 cm on paper = 10 cm in pit)

3. Draw an arrow here pointing in the direction of North on your plan:

5. Complete the boxes below to show what (apart from finds) was in this context (write non-listed inclusions into blank row if necessary):

	Present y/n	Percentage?	Particle size (tick each box that applies)		
			Flecks	Small	Med
Stone	Y	% 15	<input checked="" type="checkbox"/>	<input checked="" type="checkbox"/>	<input type="checkbox"/>
Sand		%	<input type="checkbox"/>	<input type="checkbox"/>	<input type="checkbox"/>
Soil	Y	% 84	<input checked="" type="checkbox"/>	<input checked="" type="checkbox"/>	<input checked="" type="checkbox"/>
Clay		%	<input type="checkbox"/>	<input type="checkbox"/>	<input type="checkbox"/>
Charcoal		%	<input type="checkbox"/>	<input type="checkbox"/>	<input type="checkbox"/>
		%	<input type="checkbox"/>	<input type="checkbox"/>	<input type="checkbox"/>
		%	<input type="checkbox"/>	<input type="checkbox"/>	<input type="checkbox"/>

6. What colour was this context?: **3/4**

7. List the finds from this context. For each find, say what it is (or what it looks like) and what date it is (if you know).

glass
coal
bone
unglazed pot

Context plan

4. Describe what you've drawn on the plan, adding any notes which help explain what you have shown on your plan:

Context Record Sheet

Site code: **SBD F15** Test Pit number: **51** Context number: **7**

Context recorded by: **Dave Brooks**

Recording task checklist	
Task	Tick when completed
Photograph top of layer before starting to dig it	<input checked="" type="checkbox"/>
Draw plan of top of context before starting to dig it	<input checked="" type="checkbox"/>
Dig context, sieve spoil, keep and record finds (record percentage sieved)	<input checked="" type="checkbox"/> %
Clean finds and place in clearly labelled finds tray to dry with labeled bag	<input type="checkbox"/>
Fill in all of this Context Record Sheet	<input type="checkbox"/>

1. What depth is the surface of the top of this context at the four corners of your test pit (numbered in black boxes below)?
1 **60** 2 **60** 3 **60** 4 **60**

2. Make a measured, labelled plan of this context in the gridded square below (1 cm on paper = 10 cm in pit)

3. Draw an arrow here pointing in the direction of North on your plan:

5. Complete the boxes below to show what (apart from finds) was in this context (write non-listed inclusions into blank row if necessary):

	Present y/n	Percentage?	Particle size (tick each box that applies)		
			Flecks	Small	Med
Stone	Y	% 30	<input checked="" type="checkbox"/>	<input checked="" type="checkbox"/>	<input checked="" type="checkbox"/>
Sand		%	<input type="checkbox"/>	<input type="checkbox"/>	<input type="checkbox"/>
Soil	Y	% 70	<input checked="" type="checkbox"/>	<input checked="" type="checkbox"/>	<input checked="" type="checkbox"/>
Clay		%	<input type="checkbox"/>	<input type="checkbox"/>	<input type="checkbox"/>
Charcoal		%	<input type="checkbox"/>	<input type="checkbox"/>	<input type="checkbox"/>
		%	<input type="checkbox"/>	<input type="checkbox"/>	<input type="checkbox"/>
		%	<input type="checkbox"/>	<input type="checkbox"/>	<input type="checkbox"/>

6. What colour was this context?: **3/4**

7. List the finds from this context. For each find, say what it is (or what it looks like) and what date it is (if you know).

clay pipe stem

Context plan

4. Describe what you've drawn on the plan, adding any notes which help explain what you have shown on your plan:
Stone embedded - soil

(Continued on Page 11)